



City of Westminster

Licensing Sub-Committee Report

Item No:

Date:

20 July 2023

Licensing Ref No:

23/02043/LIPV - Premises Licence Variation

Title of Report:

STK At The ME Hotel (Ground Floor)
Marconi House
335 Strand
London

Report of:

Director of Public Protection and Licensing

Wards involved:

St James's

Policy context:

City of Westminster Statement of Licensing Policy

Financial summary:

None

Report Author:

Miss Jessica Donovan
Senior Licensing Officer

Contact details

Telephone: 020 7641 6500
Email: jdonovan@westminster.gov.uk

1. Application

1-A Applicant and premises			
Application Type:	Variation of a Premises Licence, Licensing Act 2003		
Application received date:	30 March 2023		
Applicant:	T.O.G. (Aldwych) Limited		
Premises:	STK At The ME Hotel (Ground Floor)		
Premises address:	Marconi House 335 Strand London WC2R 1HA	Ward:	St James's
		Cumulative Impact Area:	None
		Special Consideration Zone:	None
Premises description:	The premises currently operates as a restaurant on the Ground floor.		
Variation description:	<p>This variation seeks the following:</p> <ul style="list-style-type: none"> To extend the ambit of the area for supply of alcohol on the premises to include the external area used under a pavement licence issued by Westminster City Council in order to use a mobile bar counter in that space to serve draught beer. 		
Premises licence history:	The premises has had the benefit of a premises licence since 2011 under licence number 22/00851/LIPDPS. However, a new premises licence was granted in 2022 for the ground floor only to allow it to operate as their own entity (23/01090/LIPV). The current premises licence for the ground floor can be viewed at Appendix 3 of this report and the premises history Appendix 4 .		
Applicant submissions:	The applicant provided a mediation email which can be found at Appendix 2 .		
Applicant amendments:	None		

1-B Current and proposed licensable activities, areas and hours						
Late night refreshment						
Indoors, outdoors or both			Current :		Proposed:	
			Indoors		No change	
	Current Hours		Proposed Hours		Licensable Area	
	Start:	End:	Start:	End:	Current:	Proposed:
Monday	23:00	05:00	No change		Ground Floor	No change
Tuesday	23:00	05:00				
Wednesday	23:00	05:00				
Thursday	23:00	05:00				
Friday	23:00	05:00				
Saturday	23:00	05:00				
Sunday	23:00	05:00				
Seasonal variations/ Non-standard timings:		Current:			Proposed:	
		From the start time on New Year's Eve to the finish time on New Year's Day.			No change	

Sale by Retail of Alcohol – Residents and Bona Fide guests						
On or off sales			Current :		Proposed:	
			Both		No change	
	Current Hours		Proposed Hours		Licensable Area	
	Start:	End:	Start:	End:	Current:	Proposed:
Monday	00:00	00:00	No change		Ground Floor	Ground Floor & External area
Tuesday	00:00	00:00				
Wednesday	00:00	00:00				
Thursday	00:00	00:00				
Friday	00:00	00:00				
Saturday	00:00	00:00				
Sunday	00:00	00:00				
Seasonal variations/ Non-standard timings:		Current:			Proposed:	
		N/A			N/A	

Sale by Retail of Alcohol – Residents and Bona Fide guests						
On or off sales			Current :		Proposed:	
			Both		No change	
	Current Hours		Proposed Hours		Licensable Area	
	Start:	End:	Start:	End:	Current:	Proposed:
Monday	08:00	02:00	No change		Ground Floor	Ground Floor & External area
Tuesday	08:00	02:00				
Wednesday	08:00	02:00				
Thursday	08:00	02:00				
Friday	08:00	02:00				
Saturday	08:00	02:00				
Sunday	08:00	02:00				
Seasonal variations/ Non-standard timings:	Current: From the start time on New Year's Eve to the finish time on New Year's Day.				Proposed: No change	

Hours premises are open to the public						
	Current Hours		Proposed Hours		Premises Area	
	Start:	End:	Start:	End:	Current:	Proposed:
Monday	00:00	00:00	No change		Ground Floor	Ground Floor
Tuesday	00:00	00:00				
Wednesday	00:00	00:00				
Thursday	00:00	00:00				
Friday	00:00	00:00				
Saturday	00:00	00:00				
Sunday	00:00	00:00				
Seasonal variations/ Non-standard timings:	Current: N/A				Proposed: N/A	

1-C	Layout alteration
To extend the ambit of the area for supply of alcohol to include the external area used in order to use a mobile bar counter to serve draught beer.	
A copy of the plan can be found at Appendix 1 .	

1-D	Conditions proposed to be added
Alcohol may be supplied from a mobile unit located in the area coloured red on the approved plan by waiter/waitress service, to customers seated at tables and chairs immediately outside the premises in a space approved by the City Council for such purposes. The mobile unit shall cease service at 23.00 and shall be taken inside the premises. There shall be no cash sales from the mobile unit which shall be monitored by staff at all times.	

2. Representations

2-A Responsible Authorities	
Responsible Authority:	Environmental Health Service
Representative:	Sally Fabbriatore
Received:	21 April 2023

I refer to the application for a variation Premises Licence for the above premises. The premises already benefits from a premises licence, 22/01007/LIPN.

This representation is based on the Operating Schedule and the submitted plans, showing the external area. A plan will need to be provided showing the whole licensed area with reference to the outside area as indicated in the application.

The applicant is seeking to *extend the ambit of the area for supply of alcohol on the premises to include the external area used under a pavement licence issued by Westminster City Council in order to use a mobile bar counter in that space to serve draught beer.*

I wish to make the following representation in relation to the above application:

The addition of a mobile bar in the external area outside of the premises may cause an increase in Public Nuisance in the area, it may also impact on Public Safety.

It is believed that the proposed area is WCC land and so the impact of adding a bar to this land needs to be fully considered. Clarification is required as to whether this would be deemed an on sale or off sale of alcohol. The following condition is proposed:

'There shall be no off sales of alcohol from the mobile unit save to the tables and chairs immediately outside the premises in a space approved by the City Council for such purposes.'

Further conditions may be proposed by Environmental Health in order to help prevent Public Nuisance and protect Public Safety.

The granting of the variation Premises Licence as presented would have the likely effect of causing an increase in Public Nuisance in the area and may impact on Public Safety.

Should you wish to discuss the matter further please do not hesitate to contact me.

2-B Other Persons			
Name:		[REDACTED]	
Address and/or Residents Association:		[REDACTED] [REDACTED] [REDACTED] [REDACTED]	
Status:	Valid	In support or opposed:	Opposed
Received:	25 April 2023		

[REDACTED], London who is [REDACTED] to proposed site of license application, submits following objections:

- i. Crowding whether seated or standing near [REDACTED] may track [REDACTED] which is a [REDACTED]. Noise and other disturbances will affect [REDACTED] functioning.
- ii. Since [REDACTED] and ME Hotel [REDACTED] at [REDACTED] and [REDACTED], any activity which may potentially obstruct vehicular access at any time, should not be permitted near [REDACTED]. This area is also used to provide access [REDACTED] seekers, which may be hindered by proposed license.
- iii. A gathering specifically under the effect of alcohol near [REDACTED] may compromise or [REDACTED].
- iv. Activities which may potentially cause disturbances including noise, lights, litter, crowd etc to [REDACTED], should not be permitted.
- v. This area is frequented by students, many of them are below the legal age for drinking. Such a development is not conducive for students.

3. Policy & Guidance

The following policies within the City Of Westminster Statement of Licensing Policy apply:

Policy HRS1 applies

- A. Applications within the core hours set out below in this policy will generally be granted for the relevant premises uses, subject to not being contrary to other policies in the Statement of Licensing Policy.
- B. Applications for hours outside the core hours set out in Clause C will be considered on their merits, subject to other relevant policies, and with particular regard to the following:
1. The demonstration of compliance in the requirements of policies CD1, PS1, PN1 and CH1 associated with the likelihood of the effect of the grant of a licence for later or earlier hours on crime and disorder, public safety, public nuisance and the protection of children from harm.
 2. If the application is located within a Special Consideration Zone they have demonstrated that they have taken account of the issues identified in that area and provided adequate mitigation.
 3. Whether there is residential accommodation in the proximity of the premises that would likely be adversely affected by premises being open or carrying out operations at the hours proposed.
 4. The proposed hours of the licensable activities and when customers will be permitted to remain on the premises.
 5. The proposed hours when any music, including incidental music, will be played.
 6. The hours when customers will be allowed to take food or drink outside the premises or be within open areas which form part of the premises.
 7. The existing hours of licensable activities and the past operation of the premises (if any) and hours of licensable premises in the vicinity.
 8. Whether customers and staff have adequate access to public transport when arriving at and leaving the premises, especially at night.
 9. The capacity of the premises.
 10. The type of use, recognising that some venues are more likely to impact the licensing objectives than others; for example, pubs and bars are higher risk than theatres, cinemas and other cultural and sporting venues due to the nature of the operation.
 11. The Licensing Authority will take into account the active measures proposed for a 'winding down' period including arrangements for people to be collected from the premises to travel home safely.
 12. Conditions on hours may be attached that require that the supply of alcohol for consumption on the premises ceases a suitable period of time before customers are required to leave the premises.
 13. The council, acting as the Licensing Authority, may reduce hours if, after review, it is necessary to impose conditions specifying shorter hours in order to promote the licensing objectives.
 14. Specific days for non-standard hours should be identified and justified as part of the application to allow responsible authorities and interested parties to evaluate the impact that these licensable activities may have, and to plan accordingly. The consideration of applications for later hours for Bank Holiday Mondays will take into account that later hours are generally granted for preceding Sundays and that the next day is a working day. Non-specific days

	<p>are expected to be covered by Temporary Event Notices or variation applications.</p> <p>C. For the purpose of Clauses A and B above, the Core Hours for applications for each premises use type as defined within this policy are:</p> <ol style="list-style-type: none"> 1. Casinos: Up to 24 hours a day whilst casino gaming is permitted by a premises licence under the Gambling Act 2005. 2. Cinemas, Cultural Venues and Live Sporting Premises: Monday to Sunday: 9am to 12am 3. Hotels: Monday to Thursday: 9am to 11.30pm. Friday and Saturday: 9am to 12am. Sunday: 9am to 10.30pm. Sundays immediately prior to a bank holiday: 9am to 12am. For the sale of alcohol to guests for consumption in hotel/guest rooms only: Anytime up to 24 hours. 4. Off licences: Monday to Saturday: 8am to 11pm. Sunday: 9am to 10.30pm. 5. Outdoor Spaces: Monday to Thursday: 9am to 11.30pm. Friday and Saturday: 9am to 12am. Sunday: 9am to 10.30pm. Sundays immediately prior to a bank holiday: 9am to 12am. 6. Pubs and bars, Fast Food and Music and Dance venues: Monday to Thursday: 10am to 11.30pm. Friday and Saturday: 10am to 12am. Sunday: 9am to 10.30pm. Sundays immediately prior to a bank holiday: 12pm to 12am. 7. Qualifying Clubs: Monday to Thursday: 9am to 12am.. Friday and Saturday: 9am to 12am. Sunday: 9am to 10.30pm. Sundays immediately prior to a bank holiday: 9am to 12am. 8. Restaurants: Monday to Thursday: 9am to 11.30pm. Friday and Saturday: 9am to 12am. Sunday: 9am to 10.30pm. Sundays immediately prior to a bank holiday: 9am to 12am. 9. Sexual Entertainment Venues and Sex Cinemas: Monday to Thursday: 9am to 11.30pm. Friday and Saturday: 9am to 12am. Sunday: 9am to 10.30pm. Sundays immediately prior to a bank holiday: 9am to 12am. <p>D. Core hours are when customers are permitted to be on the premises and therefore the maximum opening hours permitted will be to the same start and terminal hours for each of the days where licensable activity is permitted.</p> <p>E. For the purposes of this policy, 'premises uses' are defined within the relevant premises use policies within this statement.</p>
<p>Policy RNT1 applies</p>	<p>A. Applications outside the West End Cumulative Impact Zone will generally be granted subject to:</p> <ol style="list-style-type: none"> 1. The application meeting the requirements of policies CD1, PS1, PN1 and CH1. 2. The hours for licensable activities being within the council's Core Hours Policy HRS1. 3. The operation of any delivery services for alcohol and/or latenight refreshment meeting the council's Ancillary Delivery of Alcohol and/or Late-Night Refreshment Policy DEL1. 4. The applicant has taken account of the Special Consideration Zones Policy SCZ1 if the premises are located within a designated zone. 5. The application and operation of the venue meeting the definition of a restaurant as per Clause C. <p>B. Applications inside the West End Cumulative Impact Zone will generally be granted subject to:</p>

	<ol style="list-style-type: none"> 1. The application meeting the requirements of policies CD1, PS1, PN1 and CH1. 2. The hours for licensable activities are within the council's Core Hours Policy HRS1. 3. The operation of any delivery services for alcohol and/or latenight refreshment meeting the council's Ancillary Delivery of Alcohol and/or Late-Night Refreshment Policy DEL1. 4. The applicant has demonstrated that they will not add to cumulative impact within the Cumulative Impact Zone. 5. The application and operation of the venue meeting the definition of a restaurant as per Clause C. <p>C. For the purposes of this policy a restaurant is defined as:</p> <ol style="list-style-type: none"> 1. A premises in which customers are shown to their table or the customer will select a table themselves to which food is either served to them or they have collected themselves. 2. Which provide food in the form of substantial table meals that are prepared on the premises and are served and consumed at a table. 3. Which do not provide any takeaway service of food and/or drink for immediate consumption, except if provided via an ancillary delivery service to customers at their residential or workplace address. 4. Where alcohol shall not be sold, supplied, or consumed on the premises otherwise than to persons who are bona fide taking substantial table meals and provided always that the consumption of alcohol by such persons is ancillary to taking such meals. 5. The sale and consumption of alcohol prior to such meals may be in a bar area but must also be ancillary to the taking of such meal.
--	--

4. Equality Implications

The Council in its capacity as Licensing Authority has a duty to have regard to its public sector equality duty under section 149 of the Equality Act 2010. In summary, section 149 provides that a Public Authority must, in the exercise of its functions, have due regard to the need to:

- (a) eliminate discrimination harassment, victimisation and any other conduct that is prohibited by or under this Act;
- (b) advance equality of opportunity between persons who share a relevant protected characteristic and persons who do not share it; and
- (c) foster good relations between persons who share a relevant protected characteristics and persons who do not share it.

Section 149 (7) of the Equality Act 2010 defines the relevant protected characteristics as age, disability, gender reassignment, marriage and civil partnership, pregnancy and maternity, race, religion or belief, sex, and sexual orientation.

5. Appendices

Appendix 1	Premises plans
Appendix 2	Applicant supporting documents
Appendix 3	Existing Premises Licence 23/01090/LIPV
Appendix 4	Premises history
Appendix 5	Proposed conditions
Appendix 6	Residential map and list of premises in the vicinity

Report author:	Miss Jessica Donovan Senior Licensing Officer
Contact:	Telephone: 020 7641 6500 Email: jdonovan@westminster.gov.uk

If you have any queries about this report or wish to inspect one of the background papers please contact the report author.

Background Documents – Local Government (Access to Information) Act 1972

1	Licensing Act 2003	N/A
2	City of Westminster Statement of Licensing Policy	01 October 2021
3	Amended Guidance issued under section 182 of the Licensing Act 2003	December 2022
4	Environmental Health Service Representation	21 April 2023
5	Interested party representation	25 April 2023

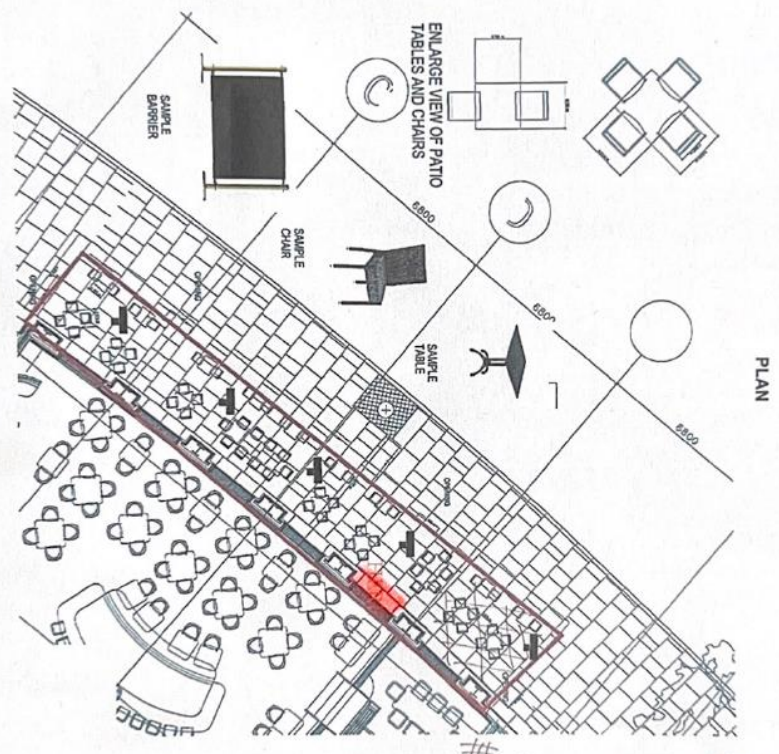

20/0978451TCPL

SWANKING-
NEAR
Depth L. 876
M.
width 32.400
M.

Mediation with Interested Party

From: jdonovan@westminster.gov.uk
To: "Vikas Kumar" <Attpnm.london@mea.gov.in>
Sent: Friday, May 26, 2023 9:53:12 AM
Subject: 23/02043/LIPV-STK At The ME Hotel (Ground FI), Marconi House, 335 Strand, London

Dear Mr Kumar,

Following your representation on the above application, the applicant's representative has asked the Licensing Service to pass on the following information for your consideration.

1. He appears to be under the misapprehension that this is an application to somehow extend the licensed area.
2. The fact is that the area which is subject of the application is already licensed by the City Council under a pavement licence and is already being used by the restaurant
3. This application does not enlarge the area that is already being used. It is simply an application to use the area in a different way.
4. Alcohol can already be consumed in this area. This application simply changes the way the alcohol is served outside to customers seated at tables there.

If the above information satisfies your concerns and you wish to withdraw please let us know.

If you still have concerns and wish to mediate with the applicant's representative please confirm you are happy for us to pass on your email address to them.

Kind Regards

Jessica Donovan
Senior Licensing Officer
Public Protection and Licensing
Westminster City Council
15th Floor
Westminster City Hall
64 Victoria Street
London SW1E 6QP

From: [Vikas Kumar](#)
To: [Donovan, Jessica: WCC](#)
Cc: sspnm.london@mea.gov.in
Subject: Re: 23/02043/LIPV-STK At The ME Hotel (Ground FI), Marconi House, 335 Strand, London
Date: 06 June 2023 11:38:41
Attachments: [image001.png](#)
[image002.png](#)

Dear Ms. Jessica,

Reference – your email dated 26 May 2023 (trailed below).

Our concerns submitted to WCC on 25 April 2023 still remain unaddressed. It is reiterated that the High Commission is a diplomatic Mission, which organizes frequent diplomatic and other outreach events at its premises, involving dignitaries not only from India and the UK but from all other countries. Thus, large public events around and adjacent to the High Commission,

specifically under the influence of alcohol increases noise, litter and hinders access especially to visitors who commute on foot to attend the High Commission's events, while also increasing insecurity for the Mission Staff, especially as the conversion of public space into open air areas for congregation offers opportunity for hostile actors to reconnoitre and keep under surveillance our staff and Mission.

2. WCC is also aware that two bus stands have been placed in front of the High Commission despite our concerns. One of those is exactly where a restaurant has made seating area under the license application. This area with a standing crowd waiting for buses towards the entrance of High Commission of India has implications for security of the High Commission.

3. It is also important to reiterate that since this area is frequented by students, many of whom are below the legal age for drinking, WCC is requested to not permit serving of alcohol in the open.

Kind regards,

Vikas Kumar/ विकास कुमार
Attache (Project & Maintenance Wing)
High Commission of India
Aldwych, London WC2B 4NA



City of Westminster
64 Victoria Street, London,
SW1E 6QP

Schedule 12
Part A

WARD: St James's
UPRN: 010033615771

Premises licence

Regulation 33, 34

Premises licence
number:

23/01090/LIPV

Original Reference:

22/01007/LIPN

Part 1 – Premises details

Postal address of premises:

STK at the ME Hotel (Ground Floor)
Marconi House
335 Strand
London
WC2R 1HA

Telephone Number: Not Supplied

Where the licence is time limited, the dates:

Not applicable

Licensable activities authorised by the licence:

Late Night Refreshment
Sale by Retail of Alcohol

The times the licence authorises the carrying out of licensable activities:

Late Night Refreshment

Monday to Sunday: 23:00 to 05:00

Non-standard Timings: From the start time on New Year's Eve to the finish time on New Year's Day

Sale by Retail of Alcohol

Monday to Sunday: 00:00 to 00:00 (Residents and bona fide guests)

Monday to Sunday: 08:00 to 02:00

Non-standard Timings: From the start time on New Year's Eve to the finish time on New Year's Day

The opening hours of the premises:

Monday to Sunday: 00:00 to 00:00

Where the licence authorises supplies of alcohol, whether these are on and/or off supplies:

Alcohol is supplied for consumption both on and off the Premises.

Part 2

Name, (registered) address, telephone number and email (where relevant) of holder of premises licence:

T.O.G. (Aldwych) Limited
Acre House
11/15 William Road
London
NW1 3ER

Registered number of holder, for example company number, charity number (where applicable)

07608198

Name, address and telephone number of designated premises supervisor where the premises licence authorises the supply of alcohol:

Name: Mr Kyle Gibson

Please note: It is the policy of the Licensing Authority not to display the address details of a designated premises supervisor.

Personal licence number and issuing authority of personal licence held by designated premises supervisor where the premises licence authorises for the supply of alcohol:

Licence Number: 14905
Licensing Authority: London Borough of Tower Hamlets

Date: 24 March 2023

This licence has been authorised by Kevin Jackaman on behalf of the Director - Public Protection and Licensing.

Annex 1 – Mandatory conditions

1. No supply of alcohol may be made at a time when there is no designated premises supervisor in respect of this licence.
2. No supply of alcohol may be made at a time when the designated premises supervisor does not hold a personal licence or the personal licence is suspended.
3. Every supply of alcohol under this licence must be made or authorised by a person who holds a personal licence.
4.
 - (1) The responsible person must ensure that staff on relevant premises do not carry out, arrange or participate in any irresponsible promotions in relation to the premises.
 - (2) In this paragraph, an irresponsible promotion means any one or more of the following activities, or substantially similar activities, carried on for the purpose of encouraging the sale or supply of alcohol for consumption on the premises—
 - (a) games or other activities which require or encourage, or are designed to require or encourage, individuals to;
 - (i) drink a quantity of alcohol within a time limit (other than to drink alcohol sold or supplied on the premises before the cessation of the period in which the responsible person is authorised to sell or supply alcohol), or
 - (ii) drink as much alcohol as possible (whether within a time limit or otherwise);
 - (b) provision of unlimited or unspecified quantities of alcohol free or for a fixed or discounted fee to the public or to a group defined by a particular characteristic in a manner which carries a significant risk of undermining a licensing objective;
 - (c) provision of free or discounted alcohol or any other thing as a prize to encourage or reward the purchase and consumption of alcohol over a period of 24 hours or less in a manner which carries a significant risk of undermining a licensing objective;
 - (d) selling or supplying alcohol in association with promotional posters or flyers on, or in the vicinity of, the premises which can reasonably be considered to condone, encourage or glamorise anti-social behaviour or to refer to the effects of drunkenness in any favourable manner;
 - (e) dispensing alcohol directly by one person into the mouth of another (other than where that other person is unable to drink without assistance by reason of a disability).
5. The responsible person must ensure that free potable water is provided on request to customers where it is reasonably available.
6.
 - (1) The premises licence holder or club premises certificate holder must ensure that an age verification policy is adopted in respect of the premises in relation to the sale or supply of alcohol.
 - (2) The designated premises supervisor in relation to the premises licence must ensure that the supply of alcohol at the premises is carried on in accordance with the age verification policy.

- (3) The policy must require individuals who appear to the responsible person to be under 18 years of age (or such older age as may be specified in the policy) to produce on request, before being served alcohol, identification bearing their photograph, date of birth and either—
 - (a) a holographic mark, or
 - (b) an ultraviolet feature.

- 7. The responsible person must ensure that—
 - (a) where any of the following alcoholic drinks is sold or supplied for consumption on the premises (other than alcoholic drinks sold or supplied having been made up in advance ready for sale or supply in a securely closed container) it is available to customers in the following measures—
 - (i) beer or cider: ½ pint;
 - (ii) gin, rum, vodka or whisky: 25 ml or 35 ml; and
 - (iii) still wine in a glass: 125 ml;
 - (b) these measures are displayed in a menu, price list or other printed material which is available to customers on the premises; and
 - (c) where a customer does not in relation to a sale of alcohol specify the quantity of alcohol to be sold, the customer is made aware that these measures are available.

A responsible person in relation to a licensed premises means the holder of the premise licence in respect of the premises, the designated premises supervisor (if any) or any individual aged 18 or over who is authorised by either the licence holder or designated premises supervisor. For premises with a club premises certificate, any member or officer of the club present on the premises in a capacity that which enables him to prevent the supply of alcohol.

8(i) A relevant person shall ensure that no alcohol is sold or supplied for consumption on or off the premises for a price which is less than the permitted price.

8(ii) For the purposes of the condition set out in paragraph 8(i) above -

- (a) "duty" is to be construed in accordance with the Alcoholic Liquor Duties Act 1979;
- (b) "permitted price" is the price found by applying the formula -

$$P = D + (D \times V)$$

Where -

- (i) P is the permitted price,
 - (ii) D is the amount of duty chargeable in relation to the alcohol as if the duty were charged on the date of the sale or supply of the alcohol, and
 - (iii) V is the rate of value added tax chargeable in relation to the alcohol as if the value added tax were charged on the date of the sale or supply of the alcohol;
- (c) "relevant person" means, in relation to premises in respect of which there is in force a premises licence -
 - (i) the holder of the premises licence,
 - (ii) the designated premises supervisor (if any) in respect of such a licence, or

- (iii) the personal licence holder who makes or authorises a supply of alcohol under such a licence;
 - (d) "relevant person" means, in relation to premises in respect of which there is in force a club premises certificate, any member or officer of the club present on the premises in a capacity which enables the member or officer to prevent the supply in question; and
 - (e) "value added tax" means value added tax charged in accordance with the Value Added Tax Act 1994.
- 8(iii). Where the permitted price given by Paragraph 8(ii)(b) above would (apart from this paragraph) not be a whole number of pennies, the price given by that sub-paragraph shall be taken to be the price actually given by that sub-paragraph rounded up to the nearest penny.
- 8(iv). (1) Sub-paragraph 8(iv)(2) below applies where the permitted price given by Paragraph 8(ii)(b) above on a day ("the first day") would be different from the permitted price on the next day ("the second day") as a result of a change to the rate of duty or value added tax.
- (2) The permitted price which would apply on the first day applies to sales or supplies of alcohol which take place before the expiry of the period of 14 days beginning on the second day.
9. All persons guarding premises against unauthorised access or occupation or against outbreaks of disorder or against damage (door supervisors) must be licensed by the Security Industry Authority.

Annex 2 – Conditions consistent with the operating Schedule

10. After 01.00 hours, the sale of alcohol will be ancillary to food, consumed by seated persons, supplied by waiter / waitress.
11. Substantial food and non-intoxicating beverages, including drinking water, shall be available on the premises where alcohol is sold or supplied for consumption on the premises.
12. The supply of alcohol shall be by waiter or waitress service or bar service.
13. The supply of alcohol for consumption 'Off' the premises shall only be,
 - (i) In sealed containers ancillary to a take-away meal
 - (ii) To persons seated at the outside tables and chairs by waiter/waitress service.
14. There will be no self-service of alcohol.
15. A Challenge 21 or Challenge 25 proof of age scheme shall be operated at the premises where the only acceptable forms of identification are recognised photographic identification cards, such as a driving licence, passport or proof of age card with the PASS Hologram.
16. The number of persons permitted in the premises between 01.00 hours and 02.00 hours (excluding staff) shall not exceed 200 persons.
17. All beers and lagers sold in glass bottles are to be decanted into drinking containers prior to being served.
18. The premises shall install and maintain a comprehensive CCTV system as per the minimum requirements of the Westminster Police Licensing Team. All entry and exit points will be covered enabling frontal identification of every person entering in any light condition. The CCTV system shall continually record whilst the premises is open for licensable activities and during all times when customers remain on the premises and will include the external area immediately outside the premises. All recordings shall be stored for a minimum period of 31 days with date and time stamping. Viewing of recordings shall be made available immediately upon the request of Police or authorised officer throughout the entire 31 day period.
19. A staff member from the premises who is conversant with the operation of the CCTV system shall be on the premises at all times when the premises are open. This staff member must be able to provide a Police or authorised council officer copies of recent CCTV images or data with the absolute minimum of delay when requested.
20. An incident log shall be kept at the premises, and made available on request to an authorised officer of the City Council or the Police, which will record the following:
 - (a) all crimes reported to the venue
 - (b) b) all ejections of patrons
 - (c) c) any complaints received concerning crime and disorder
 - (d) any incidents of disorder
 - (e) all seizures of drugs or offensive weapons
 - (f) any faults in the CCTV system or searching/scanning equipment
 - (g) any refusal of the sale of alcohol
 - (h) any visit by a relevant authority or emergency service.
21. There shall be no new entry for non-residents after 00:30 hours.

22. Patrons permitted to temporarily leave and then re-enter the premises, e.g. to smoke, shall not be permitted to take drinks or glass containers with them.
23. Alcohol consumed outside the premises building shall only be consumed by patrons seated at tables.
24. All tables and chairs shall be removed from the outside area by 23.00 hours each day
25. The Supply of Alcohol to members of the public shall be permitted from the end of permitted hours on New Year's Eve to the start of permitted hours on New Year's Day.
26. Where licensable activity is permitted, a minimum of one SIA registered door supervisor shall be on duty at the external entrance to the premises from 21.00 hours on Thursday to Saturday.
27. On Sundays to Wednesdays the requirement for and number of SIA door supervisors after 21.00 hours each day shall be risk assessed by the premises licence holder or DPS dependent upon the occasion, such risk assessment shall be kept at the premises for a minimum of 21 days following the occasion.
28. A noise limiter must be fitted to the musical amplification system set at a level determined by and in consultation with local residents to the satisfaction of an authorised officer of the Environmental Health Service, Premises Management so as to ensure that no noise nuisance is caused to local residents or businesses. The operational panel of the noise limiter shall then be secured by key or password to the satisfaction of officers from the Environmental Health Service and access shall only be by persons authorised by the Premises Licence holder. The limiter shall not be altered without prior agreement with the Environmental Health Service. No alteration or modification to any existing sound system(s) should be effected without prior knowledge of an authorised Officer of the Environmental Health Service. No additional sound generating equipment shall be used on the premises without being routed through the sound limiter device.
29. Loudspeakers shall not be located in the entrance lobby or external to the premises building.
30. No noise generated on the premises, or by its associated plant or equipment, shall emanate from the premises nor vibration be transmitted through the structure of the premises which gives rise to a nuisance.
31. No fumes, steam or odours shall be emitted from the licensed premises so as to cause a nuisance to any persons living or carrying on business in the area where the premises are situated.
32. Notices shall be prominently displayed at all exits requesting patrons to respect the needs of local residents and to leave the premises and the area quietly.
33. Notices shall be prominently displayed at any area used for smoking requesting patrons to respect the needs of local residents and use the area quietly.
34. During the hours of operation of the premises, the licence holder shall ensure sufficient measures are in place to remove and prevent litter or waste arising or accumulating from customers in the area immediately outside the premises, and that this area shall be swept and or washed, and litter and sweepings collected and stored in accordance with the approved refuse storage arrangements by close of business.
35. All deliveries shall be to the service road leading to the basement delivery area.

36. All refuse will be stored internally prior to collection.
37. No rubbish including bottles will be moved, removed or placed in outside areas between 23.00 hours and 07.00 hours.
38. The approved arrangements at the premises, including means of escape provisions, emergency warning equipment, the electrical installation and mechanical equipment, shall at all material times be maintained in good condition and full working order.
39. The means of escape provided for the premises shall be maintained unobstructed, free of trip hazards, be immediately available and clearly identified in accordance with the plans provided.
40. All emergency exit doors shall be available at all material times without the use of a key, code, card or similar means.
41. All emergency doors shall be maintained effectively self-closing and not held open other than by an approved device.
42. Curtains and hangings shall be arranged so as not to obstruct emergency safety signs or emergency equipment.
43. The edges of the treads of steps and stairways shall be maintained so as to be conspicuous.
44. All fabrics, curtains, drapes and similar features including materials used in finishing and furnishing should be either non-combustible or be durably or inherently flame-retarded fabric. Any fabrics used in escape routes, other than foyers, entertainment areas or function rooms, should be non-combustible.
45. Any condition on this licence relating to live music will have effect and section 177A will not apply to such conditions.

Annex 3 – Conditions attached after a hearing by the licensing authority

None

Annex 4 – Plans

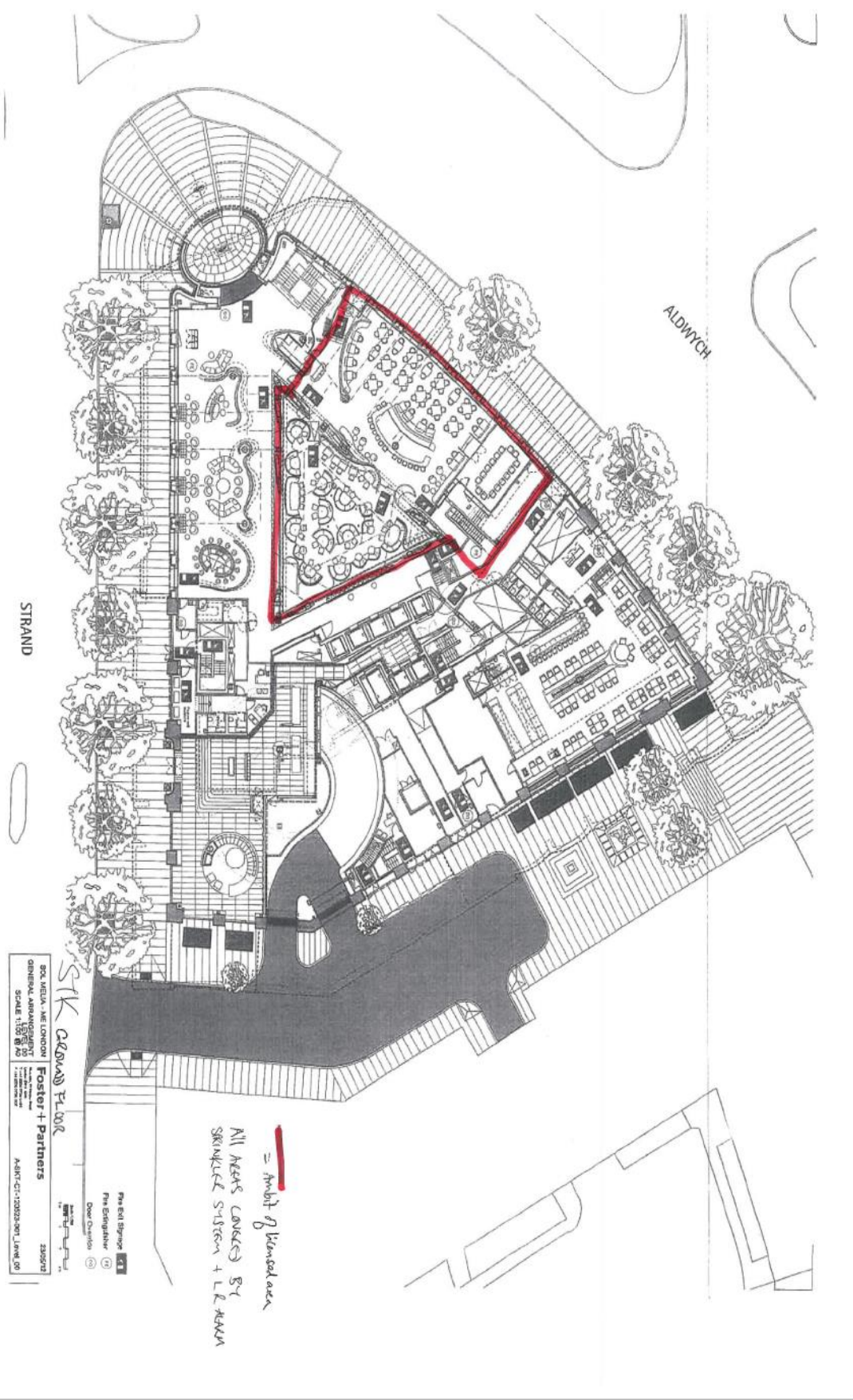



City of Westminster
64 Victoria Street, London,
SW1E 6QP

Schedule 12
Part B

Premises licence
summary

WARD: St James's
UPRN: 010033615771

Regulation 33, 34

Premises licence
number:

23/01090/LIPV

Part 1 – Premises details

Postal address of premises:

STK At The ME Hotel (Ground Floor)
Marconi House
335 Strand
London
WC2R 1HA

Telephone Number: Not Supplied

Where the licence is time limited, the dates:

Not applicable

Licensable activities authorised by the licence:

Late Night Refreshment
Sale by Retail of Alcohol

The times the licence authorises the carrying out of licensable activities:

Late Night Refreshment

Monday to Sunday: 23:00 to 05:00

Non-standard Timings: From the start time on New Year's Eve to the finish time on New Year's Day

Sale by Retail of Alcohol

Monday to Sunday: 00:00 to 00:00 (Residents and bona fide guests)

Monday to Sunday: 08:00 to 02:00

Non-standard Timings: From the start time on New Year's Eve to the finish time on New Year's Day

The opening hours of the premises:

Monday to Sunday: 00:00 to 00:00

Where the licence authorises supplies of alcohol, whether these are on and/or off supplies:

Alcohol is supplied for consumption both on and off the Premises.

Name and (registered) address of holder of premises licence:

T.O.G. (Aldwych) Limited
Acre House
11/15 William Road
London
NW1 3ER

Registered number of holder, for example company number, charity number (where applicable)

07608198

Name of designated premises supervisor where the premises licence authorises for the supply of alcohol:

Name: Mr Kyle Gibson

State whether access to the premises by children is restricted or prohibited:

Restricted

Date: 24 March 2023

This licence has been authorised by Kevin Jackaman on behalf of the Director - Public Protection and Licensing.

Licensing Act 2003 - Premises History 23/01090/LIPV

Application	Details of Application	Date Determined	Decision
22/01007/LIPN	New Premises Licence Late Night Refreshment: Monday to Sunday 23:00 to 05:00 Retail Sale of Alcohol (On and Off sales): Monday to Sunday 08:00 to 02:00 From the start time on New Year's Eve to the finish time on New Year's Day.	10.06.2022	Granted under Delegated Authority
23/00527/LIPVM	Minor Variation: To amend condition 26 & 27	17.02.2023	Application refused
23/01090/LIPV	Variation application: To amend condition 26 & 27	24.03.2023	Granted under Delegated Authority

Licensing Act 2003 - Premises History 22/00851/LIPDPS

Application	Details of Application	Date Determined	Decision
11/06782/LIPN	New Premises Licence Provision of facilities for Dancing Monday to Sunday: 00:01 to 00:00 (Basement Function Rooms Only) Exhibition of a Film Monday to Sunday: 00:01 to 00:00 (Basement Function Rooms Only) Provision of facilities	17.11.2011	Granted under Delegated Authority

	<p>for making Music Monday to Sunday: 00:01 to 00:00 (Basement Function Rooms Only)</p> <p>Performance of Live Music Monday to Sunday: 00:01 to 00:00 (Basement Function Rooms Only)</p> <p>Playing of Recorded Music Monday to Sunday: 00:01 to 00:00 (Basement Function Rooms Only)</p> <p>Performance of a Play Monday to Sunday: 00:01 to 00:00 (Basement Function Rooms Only)</p> <p>Late Night Refreshment Monday to Sunday: 23:00 to 05:00</p> <p>Sale by Retail of Alcohol Monday to Sunday: 00:01 to 00:00</p>		
12/01735/LIPT	Application to Transfer: Sol Melia S.A. to Lomondo LTD	23.04.2012	Granted under Delegated Authority
12/01950/LIPDPS	Application to vary the Designated Premises Supervisor	23.04.2012	Granted under Delegated Authority
12/04408/LIPVM	Minor Variation: To vary the layout of the ground floor and films for all guest bedrooms	13.06.2012	Granted under Delegated Authority
12/07063/LIPV	<p>Variation application: To incorporate the 1st floor reception area within the licensed area.</p> <p>To revise the public toilet provision and</p>	13.09.2012	Granted under Delegated Authority

	meeting/function room layout in basement. To revise seating layout on first floor roof terrace.		
13/01927/LIPV	Variation application: To amend condition 27 to permit up to 240 on the 10 th floor excluding staff To remove condition 55 and 56. To increase toilet facilities on 10 th floor and also fire exit door widths.	26.04.2013	Granted under Delegated Authority
13/02417/LIPV	Variation application: To permit a terminal hour of alcohol to the non residents on the ground floor areas of the premises with no new entry to the premises for non-residents after 00:30	30.05.2013	Granted under Delegated Authority
13/03742/LIPT	Application to Transfer: Lomondo Limited to London XXI Limited	10.06.2013	Granted under Delegated Authority
14/00248/LIPVM	Minor Variation: To add 3 additional conditions	30.01.2014	Granted under Delegated Authority
14/02293/LIPV	Variation application: To permit off sales of alcohol in unsealed containers to customers seated within the area shown edged in red on the plan.	24.04.2014	Granted under Delegated Authority
14/02904/LIPDPS	Application to vary the Designated Premises Supervisor	15.05.2014	Granted under Delegated Authority
14/04253/LIPDPS	Application to vary the Designated Premises Supervisor	20.06.2014	Granted under Delegated Authority
14/10570/LIPDPS	Application to vary the Designated Premises Supervisor	10.12.2014	Granted under Delegated Authority

	<p>Variation application: To remove condition 68.</p> <p>To permit a terminal hour for the supply of alcohol of 00:30 in the area hatched black on the plan in the south terrace of the 10th floor.</p> <p>To require the supply of alcohol to be ancillary to food after 23.00 in the area hatched black on the plan in the south terrace of the 10th floor.</p> <p>To require all patrons to be seated and served by waiter/waitress after 23:00 in the area hatched black on the plan in the south terrace of the 10th floor</p>		Refused by Licensing Sub-Committee
15/03351/LIPDPS	Application to vary the Designated Premises Supervisor	02.11.2015	Granted under Delegated Authority
15/07403/LIPDPS	Application to vary the Designated Premises Supervisor	18.09.2015	Granted under Delegated Authority
15/08328/LIPVM	Minor Variation: To install new outer doors at the main lobby entrance to the hotel.	13.10.2015	Granted under Delegated Authority
16/05795/LIPDPS	Application to vary the Designated Premises Supervisor	20.06.2016	Granted under Delegated Authority
16/08623/LIPDPS	Application to vary the Designated Premises Supervisor	24.08.2016	Granted under Delegated Authority
18/03239/LIPV	<p>Variation application: To permit regulated entertainment in the basement function rooms at any time.</p> <p>To permit recorded music in the ground floor restaurant and bar (STK) from 23.00 to midnight Sunday to</p>	17.05.2018	Granted by Licensing Sub-Committee

	Wednesday and from 23.00 to 01:00 Thursday to Saturday		
18/06018/LIPV	Variation application: To permit the use of the southern terrace area on the 10 th floor on Thursday to Saturdays until midnight. To amend condition 37	19.07.2018	Granted by Licensing Sub-Committee
18/07151/LIPDPS	Application to vary the Designated Premises Supervisor	25.07.2018	Granted under Delegated Authority
19/01701/LIPV	Variation application: To permit the use of the southern terrace area on the 10 th floor on Monday to Saturday until 01:00. To amend condition 32 To add an additional condition	17.06.2019	Granted by Licensing Sub-Committee
20/04695/LIPV	Variation application: To permit off sales of alcohol To add MC36 and MC18	23.07.2020	Granted under Delegated Authority
20/06010/LIPV	Variation application: To amend condition 37 (SIA condition)	20.08.2020	Granted under Delegated Authority
20/08205/LIPDPS	Application to vary the Designated Premises Supervisor	29.09.2020	Granted under Delegated Authority
22/00851/LIPDPS	Application to vary the Designated Premises Supervisor	11.02.2022	Granted under Delegated Authority

Temporary Event Notice History

Application	Details of Application	Date Determined	Decision
21/07604/LITENP	Temporary Event Notice	06.08.2021	Event allowed to proceed
21/07606/LITENP	Temporary Event Notice	12.08.2021	Event allowed to proceed
21/07941/LITENP	Temporary Event Notice	19.08.2021	Event allowed to proceed
21/08007/LITENP	Temporary Event Notice	25.08.2021	Event allowed to proceed

There is no appeal history

CONDITIONS CONSISTENT WITH THE OPERATING SCHEDULE AND CONDITIONS PROPOSED BY A PARTY TO THE HEARING

When determining an application for a new premises licence under the provisions of the Licensing Act 2003, the licensing authority must, unless it decides to reject the application, grant the licence subject to the conditions which are indicated as mandatory in this schedule.

At a hearing the licensing authority may, in addition, and having regard to any representations received, grant the licence subject to such conditions which are consistent with the operating schedule submitted by the applicant as part of their application, or alter or omit these conditions, or add any new condition to such extent as the licensing authority considers appropriate for the promotion of the licensing objectives.

This schedule lists those conditions which are consistent with the operating schedule, or proposed as appropriate for the promotion of the licensing objectives by a responsible authority or an interested party as indicated. These conditions have not been submitted by the licensing service but reflect the positions of the applicant, responsible authority or interested party and have not necessarily been agreed

Conditions: On Current Licence -

Mandatory:

1. No supply of alcohol may be made at a time when there is no designated premises supervisor in respect of this licence.
2. No supply of alcohol may be made at a time when the designated premises supervisor does not hold a personal licence or the personal licence is suspended.
3. Every supply of alcohol under this licence must be made or authorised by a person who holds a personal licence.
4.
 - (1) The responsible person must ensure that staff on relevant premises do not carry out, arrange or participate in any irresponsible promotions in relation to the premises.
 - (2) In this paragraph, an irresponsible promotion means any one or more of the following activities, or substantially similar activities, carried on for the purpose of encouraging the sale or supply of alcohol for consumption on the premises—
 - (a) games or other activities which require or encourage, or are designed to require or encourage, individuals to;
 - (i) drink a quantity of alcohol within a time limit (other than to drink alcohol sold or supplied on the premises before the cessation of the period in which the responsible person is authorised to sell or supply alcohol), or
 - (ii) drink as much alcohol as possible (whether within a time limit or otherwise);
 - (b) provision of unlimited or unspecified quantities of alcohol free or for a fixed or discounted fee to the public or to a group defined by a particular characteristic in a manner which carries a significant risk of undermining a licensing objective;
 - (c) provision of free or discounted alcohol or any other thing as a prize to encourage

or reward the purchase and consumption of alcohol over a period of 24 hours or less in a manner which carries a significant risk of undermining a licensing objective;

- (d) selling or supplying alcohol in association with promotional posters or flyers on, or in the vicinity of, the premises which can reasonably be considered to condone, encourage or glamorise anti-social behaviour or to refer to the effects of drunkenness in any favourable manner;
 - (e) dispensing alcohol directly by one person into the mouth of another (other than where that other person is unable to drink without assistance by reason of a disability).
5. The responsible person must ensure that free potable water is provided on request to customers where it is reasonably available.
6. (1) The premises licence holder or club premises certificate holder must ensure that an age verification policy is adopted in respect of the premises in relation to the sale or supply of alcohol.
- (2) The designated premises supervisor in relation to the premises licence must ensure that the supply of alcohol at the premises is carried on in accordance with the age verification policy.
- (3) The policy must require individuals who appear to the responsible person to be under 18 years of age (or such older age as may be specified in the policy) to produce on request, before being served alcohol, identification bearing their photograph, date of birth and either—
- (a) a holographic mark, or
 - (b) an ultraviolet feature.
7. The responsible person must ensure that—
- (a) where any of the following alcoholic drinks is sold or supplied for consumption on the premises (other than alcoholic drinks sold or supplied having been made up in advance ready for sale or supply in a securely closed container) it is available to customers in the following measures—
 - (i) beer or cider: ½ pint;
 - (ii) gin, rum, vodka or whisky: 25 ml or 35 ml; and
 - (iii) still wine in a glass: 125 ml;
 - (b) these measures are displayed in a menu, price list or other printed material which is available to customers on the premises; and
 - (c) where a customer does not in relation to a sale of alcohol specify the quantity of alcohol to be sold, the customer is made aware that these measures are available.

A responsible person in relation to a licensed premises means the holder of the premise licence in respect of the premises, the designated premises supervisor (if any) or any individual aged 18 or over who is authorised by either the licence holder or designated premises supervisor. For premises with a club premises certificate, any member or officer of the club present on the

premises in a capacity that which enables him to prevent the supply of alcohol.

8(i) A relevant person shall ensure that no alcohol is sold or supplied for consumption on or off the premises for a price which is less than the permitted price.

8(ii) For the purposes of the condition set out in paragraph 8(i) above -

(a) "duty" is to be construed in accordance with the Alcoholic Liquor Duties Act 1979;

(b) "permitted price" is the price found by applying the formula -

$$P = D+(D \times V)$$

Where -

(i) P is the permitted price,

(ii) D is the amount of duty chargeable in relation to the alcohol as if the duty were charged on the date of the sale or supply of the alcohol, and

(iii) V is the rate of value added tax chargeable in relation to the alcohol as if the value added tax were charged on the date of the sale or supply of the alcohol;

(c) "relevant person" means, in relation to premises in respect of which there is in force a premises licence -

(i) the holder of the premises licence,

(ii) the designated premises supervisor (if any) in respect of such a licence, or

(iii) the personal licence holder who makes or authorises a supply of alcohol under such a licence;

(d) "relevant person" means, in relation to premises in respect of which there is in force a club premises certificate, any member or officer of the club present on the premises in a capacity which enables the member or officer to prevent the supply in question; and

(e) "value added tax" means value added tax charged in accordance with the Value Added Tax Act 1994.

8(iii). Where the permitted price given by Paragraph 8(ii)(b) above would (apart from this paragraph) not be a whole number of pennies, the price given by that sub-paragraph shall be taken to be the price actually given by that sub-paragraph rounded up to the nearest penny.

8(iv). (1) Sub-paragraph 8(iv)(2) below applies where the permitted price given by Paragraph 8(ii)(b) above on a day ("the first day") would be different from the permitted price on the next day ("the second day") as a result of a change to the rate of duty or value added tax.

(2) The permitted price which would apply on the first day applies to sales or supplies of alcohol which take place before the expiry of the period of 14 days beginning on the second day.

9. All persons guarding premises against unauthorised access or occupation or against outbreaks of disorder or against damage (door supervisors) must be licensed by the Security Industry Authority.

Annex 2 – Conditions consistent with the operating Schedule

10. After 01.00 hours, the sale of alcohol will be ancillary to food, consumed by seated persons, supplied by waiter / waitress.
11. Substantial food and non-intoxicating beverages, including drinking water, shall be available on the premises where alcohol is sold or supplied for consumption on the premises.
12. The supply of alcohol shall be by waiter or waitress service or bar service.
13. The supply of alcohol for consumption 'Off' the premises shall only be,
 - (i) In sealed containers ancillary to a take-away meal
 - (ii) To persons seated at the outside tables and chairs by waiter/waitress service.
14. There will be no self-service of alcohol.
15. A Challenge 21 or Challenge 25 proof of age scheme shall be operated at the premises where the only acceptable forms of identification are recognised photographic identification cards, such as a driving licence, passport or proof of age card with the PASS Hologram.
16. The number of persons permitted in the premises between 01.00 hours and 02.00 hours (excluding staff) shall not exceed 200 persons.
17. All beers and lagers sold in glass bottles are to be decanted into drinking containers prior to being served.
18. The premises shall install and maintain a comprehensive CCTV system as per the minimum requirements of the Westminster Police Licensing Team. All entry and exit points will be covered enabling frontal identification of every person entering in any light condition. The CCTV system shall continually record whilst the premises is open for licensable activities and during all times when customers remain on the premises and will include the external area immediately outside the premises. All recordings shall be stored for a minimum period of 31 days with date and time stamping. Viewing of recordings shall be made available immediately upon the request of Police or authorised officer throughout the entire 31 day period.
19. A staff member from the premises who is conversant with the operation of the CCTV system shall be on the premises at all times when the premises are open. This staff member must be able to provide a Police or authorised council officer copies of recent CCTV images or data with the absolute minimum of delay when requested.
20. An incident log shall be kept at the premises, and made available on request to an authorised officer of the City Council or the Police, which will record the following:
 - (a) all crimes reported to the venue
 - (b) b) all ejections of patrons
 - (c) c) any complaints received concerning crime and disorder
 - (d) any incidents of disorder
 - (e) all seizures of drugs or offensive weapons
 - (f) any faults in the CCTV system or searching/scanning equipment
 - (g) any refusal of the sale of alcohol
 - (h) any visit by a relevant authority or emergency service.
21. There shall be no new entry for non-residents after 00:30 hours.

22. Patrons permitted to temporarily leave and then re-enter the premises, e.g. to smoke, shall not be permitted to take drinks or glass containers with them.
23. Alcohol consumed outside the premises building shall only be consumed by patrons seated at tables.
24. All tables and chairs shall be removed from the outside area by 23.00 hours each day
25. The Supply of Alcohol to members of the public shall be permitted from the end of permitted hours on New Year's Eve to the start of permitted hours on New Year's Day.
26. Where licensable activity is permitted, a minimum of one SIA registered door supervisor shall be on duty at the external entrance to the premises from 21.00 hours on Thursday to Saturday.
27. On Sundays to Wednesdays the requirement for and number of SIA door supervisors after 21.00 hours each day shall be risk assessed by the premises licence holder or DPS dependent upon the occasion, such risk assessment shall be kept at the premises for a minimum of 21 days following the occasion.
28. A noise limiter must be fitted to the musical amplification system set at a level determined by and in consultation with local residents to the satisfaction of an authorised officer of the Environmental Health Service, Premises Management so as to ensure that no noise nuisance is caused to local residents or businesses. The operational panel of the noise limiter shall then be secured by key or password to the satisfaction of officers from the Environmental Health Service and access shall only be by persons authorised by the Premises Licence holder. The limiter shall not be altered without prior agreement with the Environmental Health Service. No alteration or modification to any existing sound system(s) should be effected without prior knowledge of an authorised Officer of the Environmental Health Service. No additional sound generating equipment shall be used on the premises without being routed through the sound limiter device.
29. Loudspeakers shall not be located in the entrance lobby or external to the premises building.
30. No noise generated on the premises, or by its associated plant or equipment, shall emanate from the premises nor vibration be transmitted through the structure of the premises which gives rise to a nuisance.
31. No fumes, steam or odours shall be emitted from the licensed premises so as to cause a nuisance to any persons living or carrying on business in the area where the premises are situated.
32. Notices shall be prominently displayed at all exits requesting patrons to respect the needs of local residents and to leave the premises and the area quietly.
33. Notices shall be prominently displayed at any area used for smoking requesting patrons to respect the needs of local residents and use the area quietly.
34. During the hours of operation of the premises, the licence holder shall ensure sufficient measures are in place to remove and prevent litter or waste arising or accumulating from customers in the area immediately outside the premises, and that this area shall be swept and or washed, and litter and sweepings collected and stored in accordance with the approved refuse storage arrangements by close of business.
35. All deliveries shall be to the service road leading to the basement delivery area.

36. All refuse will be stored internally prior to collection.
37. No rubbish including bottles will be moved, removed or placed in outside areas between 23.00 hours and 07.00 hours.
38. The approved arrangements at the premises, including means of escape provisions, emergency warning equipment, the electrical installation and mechanical equipment, shall at all material times be maintained in good condition and full working order.
39. The means of escape provided for the premises shall be maintained unobstructed, free of trip hazards, be immediately available and clearly identified in accordance with the plans provided.
40. All emergency exit doors shall be available at all material times without the use of a key, code, card or similar means.
41. All emergency doors shall be maintained effectively self-closing and not held open other than by an approved device.
42. Curtains and hangings shall be arranged so as not to obstruct emergency safety signs or emergency equipment.
43. The edges of the treads of steps and stairways shall be maintained so as to be conspicuous.
44. All fabrics, curtains, drapes and similar features including materials used in finishing and furnishing should be either non-combustible or be durably or inherently flame-retarded fabric. Any fabrics used in escape routes, other than foyers, entertainment areas or function rooms, should be non-combustible.
45. Any condition on this licence relating to live music will have effect and section 177A will not apply to such conditions.

Annex 3 – Conditions attached after a hearing by the licensing authority

None

Conditions proposed to be added by the applicant

46. Alcohol may be supplied from a mobile unit located in the area coloured red on the approved plan by waiter/waitress service, to customers seated at tables and chairs immediately outside the premises in a space approved by the City Council for such purposes. The mobile unit shall cease service at 23.00 and shall be taken inside the premises. There shall be no cash sales from the mobile unit which shall be monitored by staff at all times.

Conditions proposed by the Environmental Health Service

47. There shall be no off sales of alcohol from the mobile unit save to the tables and chairs immediately outside the premises in a space approved by the City Council for such purposes.

The applicant proposes an alternative wording to condition 47 as follows:

47. There shall be no off sales of alcohol from the mobile unit.

Marconi House, 335 Strand, London, WC2R 1HA

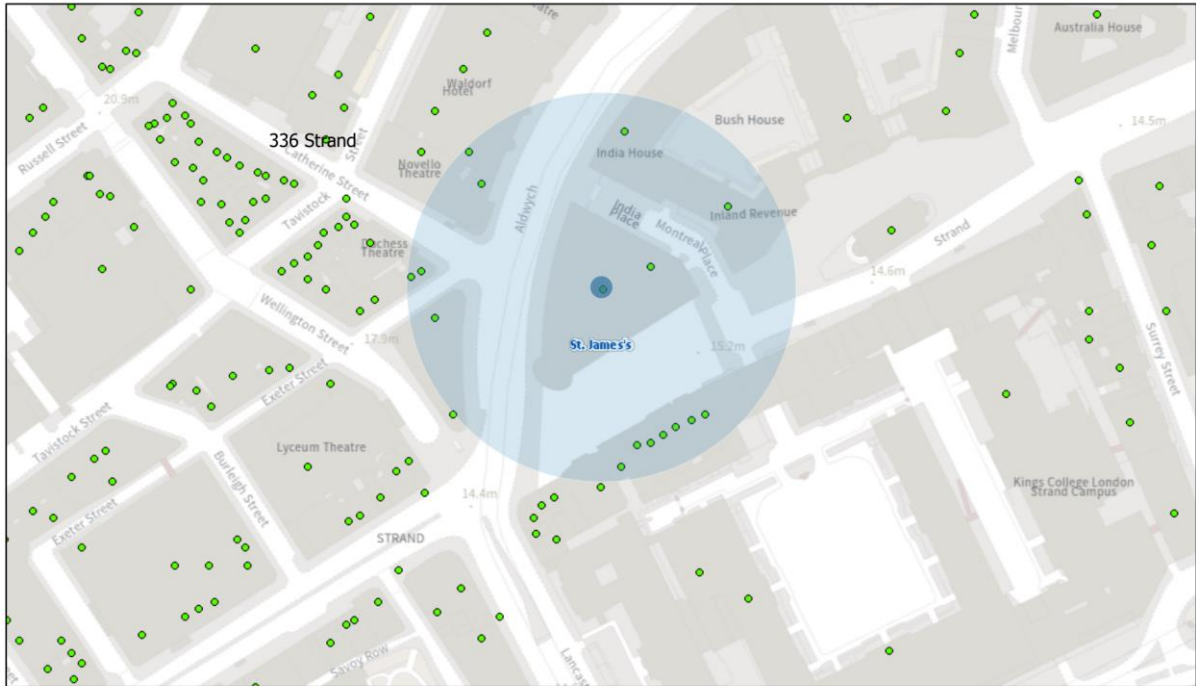

20/06/2023, 13:10:59

- Property Mailing List
- Ward Labels
- Borough Boundary - Mask
- Borough Boundary - Detailed
- Ward Boundaries

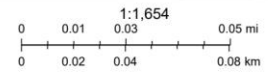

Resident Count: 96

Licensed premises within 75 metres of Marconi House, 335 Strand, London, WC2R 1HA

Licence Number	Trading Name	Address	Premises Type	Time Period
23/01090/LIPV	STK At The ME Hotel (Ground Fl)	Marconi House 335 Strand London WC2R 1HA	Restaurant	Monday; 00:00 - 00:00 Tuesday; 00:00 - 00:00 Wednesday; 00:00 - 00:00 Thursday; 00:00 - 00:00 Friday; 00:00 - 00:00 Saturday; 00:00 - 00:00 Sunday; 00:00 - 00:00
22/07259/LIPDPS	Radio At The ME Hotel (10th Floor)	Marconi House 335 Strand London WC2R 1HA	Restaurant	Monday to Sunday; 00:00 - 00:00
21/10203/LIDPSR	Not Recorded	335 Strand London WC2R 1HA	Restaurant	Sunday; 08:00 - 00:00 Monday to Thursday; 06:00 - 00:00 Friday to Saturday; 06:00 - 01:00
22/00851/LIPDPS	ME Hotel	335 Strand London WC2R 1HA	Hotel, 4+ star or major chain	Monday to Sunday; 00:01 - 00:00
21/07108/LIPN	Luciano By Gino D'Acampo	Marconi House 335 Strand London WC2R 1HA	Restaurant	Monday to Sunday; 06:30 - 02:30
22/11762/LIPDPS	Kings College London - Bush House The Vault	Bush House 30 Aldwych London WC2B 4BG	College of Further Education	Wednesday; 09:00 - 03:00 Thursday; 09:00 - 03:30 Sunday; 09:00 - 01:00 Monday to Tuesday; 09:00 - 01:30 Friday to Saturday; 09:00 - 04:00
19/03727/LIPDPS	Kings College	Bush House 30 Aldwych London WC2B 4BG	Educational	

22/09737/LIPN	Novello Cafe	7 - 9 Aldwych London WC2B 4DA	Cafe	Sunday; 08:00 - 22:30 Monday to Thursday; 08:00 - 23:30 Friday to Saturday; 08:00 - 00:00
17/13163/LIPCH	Shapur Indian Restaurant	Basement And Ground Floor 149 Strand London WC2R 1JA	Restaurant	Sunday; 12:00 - 00:00 Monday to Saturday; 10:00 - 00:30
22/01363/LIPCH	Thai Square	148 Strand London WC2R 1JA	Restaurant	Sunday; 12:00 - 00:00 Monday to Saturday; 10:00 - 00:30
22/10687/LIPDPS	Pizza Express	Ground Floor 147 Strand London WC2R 1JA	Restaurant	Sunday; 12:00 - 00:00 Monday to Saturday; 10:00 - 00:30
21/14633/LIPDPS	One Aldwych Hotel	Ground Floor To Sixth Floor 1 Aldwych London WC2B 4BZ	Hotel, 4+ star or major chain	Monday to Sunday; 00:00 - 00:00
20/02517/LIPVM	India Club	143-145 Strand London WC2R 1JA	Restaurant	Sunday; 12:00 - 22:30 Monday to Thursday; 12:00 - 23:30 Friday to Saturday; 12:00 - 00:00
06/08176/WCCMAP	Strand News	145 Strand London WC2R 1JA	Shop	Sunday; 10:00 - 22:30 Monday to Saturday; 08:00 - 23:00
19/01156/LIPDPS	Franca Manca	1 - 5 Catherine Street London WC2B 5JS	Restaurant	Sunday; 12:00 - 00:00 Monday to Saturday; 10:00 - 00:30